

myRxMedSaver™ app Flowchart

App Intro

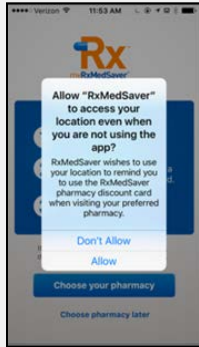

Tap "Allow"

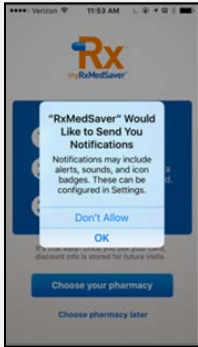

Tap "OK"



Tap "Choose your pharmacy"

My Pharmacy Tab

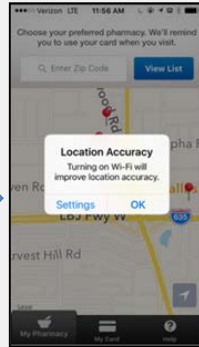

If Wi-Fi is not turned on, you will get this message. Tap "Settings" and turn on Wi-Fi.

These toasts help the user navigate through pharmacy selection

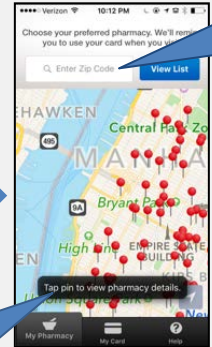

The map will automatically zoom in to your current location. Alternatively, you can enter a zip code if you'd like to view pharmacies in a different location

If preferred, tap "View List" to view the pharmacies in list format.

Tap the red pin to view pharmacy details.

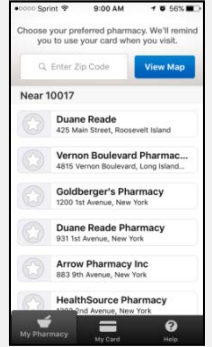

Tap grey star to choose your preferred pharmacy.

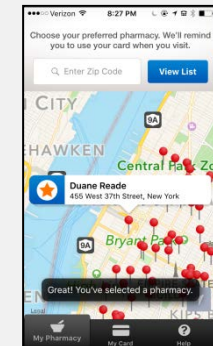

Tap grey star to choose your preferred pharmacy.

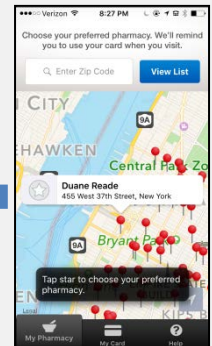

A preferred pharmacy has been selected (signified by orange star). The app will now notify you on your next pharmacy visit.

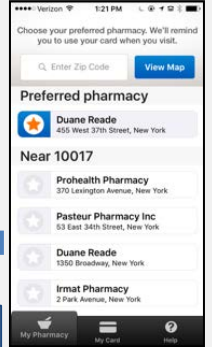

My Card Tab

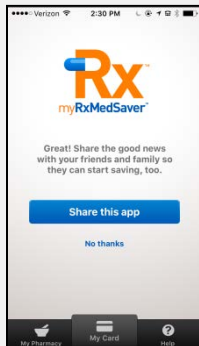

Tap "Yes"

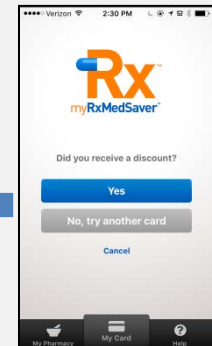

This is the first Rx Card in the deck. Show pharmacist to get discount.

Tap "Tap here when done"

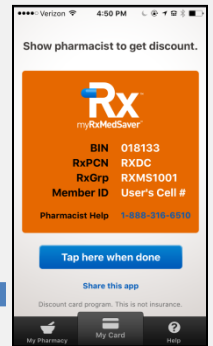

Choose pharmacy later (not recommended)

Tap "Share this app"

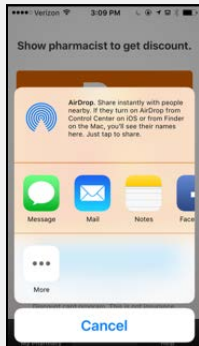

Select the distribution method you want to use to share the app. NOTE: This is unique to you based on what apps you have installed on your phone.

Tap "No, try another card"

Tap "Tap here when done"

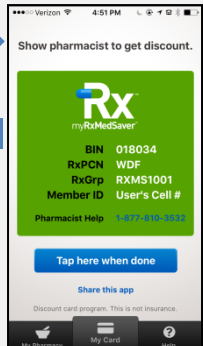

A new Rx Card will load. Present this card to the pharmacist. If no discount is received, you can try one more card. There are three cards in the deck to try. Repeat sequence as necessary.

Help Tab

The "Help" tab is a good place to start to get your questions answered. Also, a link to our website and a Contact us link can be found here.

